

LAGO

PLENUM SIDEBOARD

Istruzioni di montaggio
Assembly instructions



7IM007601

Attrezzi necessari / *Required tools*

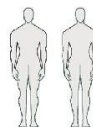
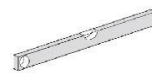
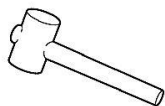

Per ulteriori delucidazioni contattare l'ufficio tecnico al n°: 049 599 42 99

Importante: Lago S.p.a. non risponde di eventuali danni a cose o persone derivanti da un errato montaggio.

For further explanations contact our technical department at no.: +39 049 599 42 99

Important: Lago S.p.a. is not responsible for possible damages to property or injuries to people deriving from incorrect assembly.

Ferramenta / Hardware



x 8

M6 x 15



x 8

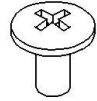

x 8

M4 x 8

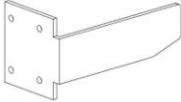

x 1 DX

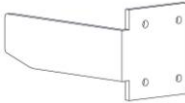

x 1 SX



x 1 DX

Cover in Plastica
Plastic cover



x 1 SX



3

x 1



x 2

Cover in Acciaio
Steel cover

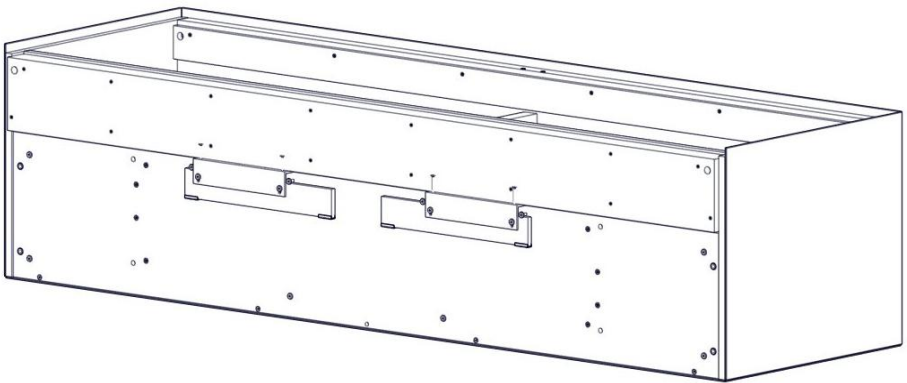

1

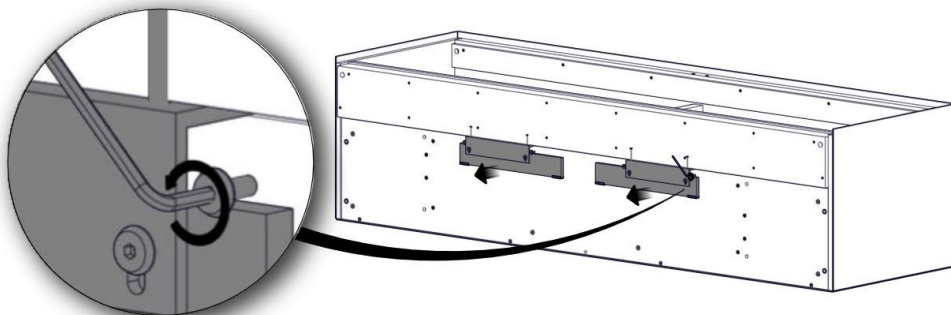
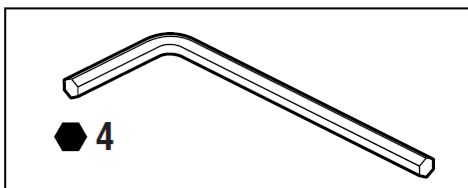

2

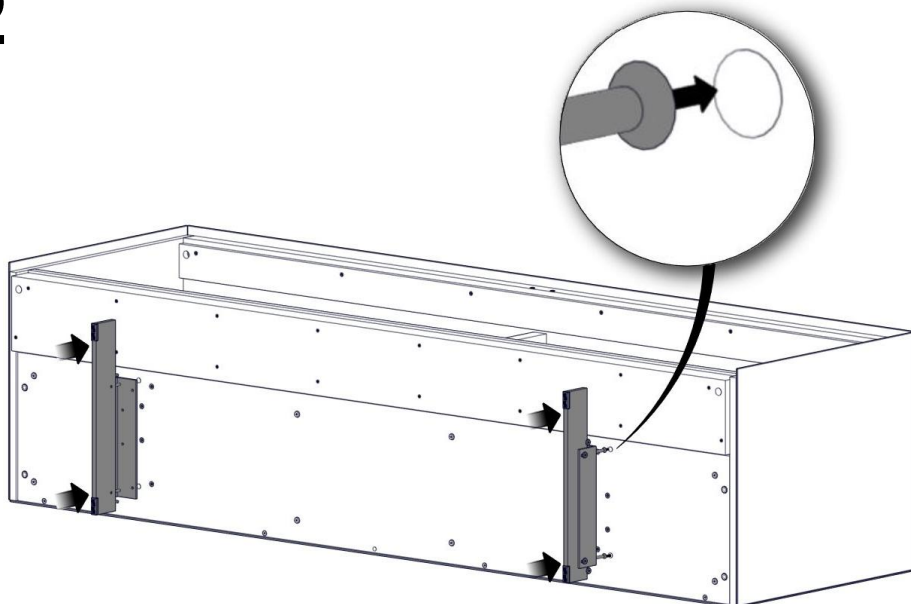

3

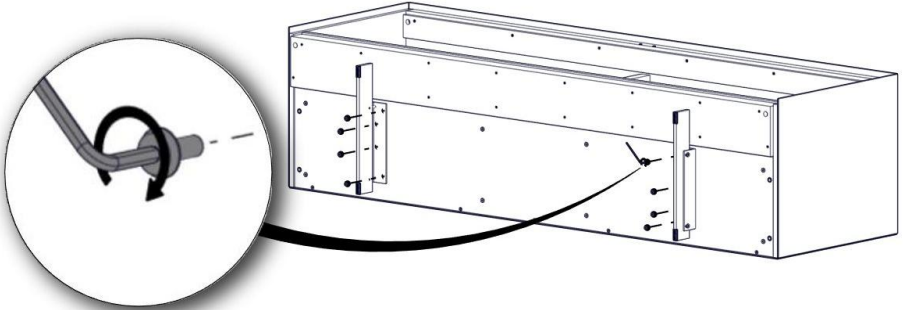
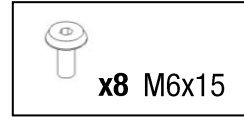
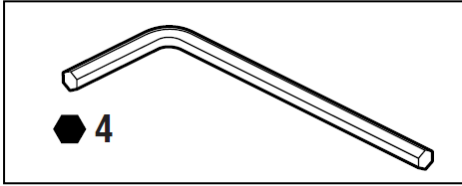

4

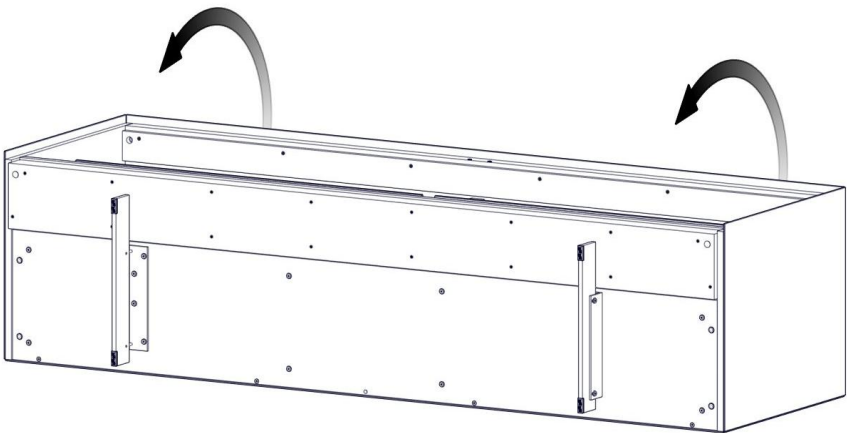

5

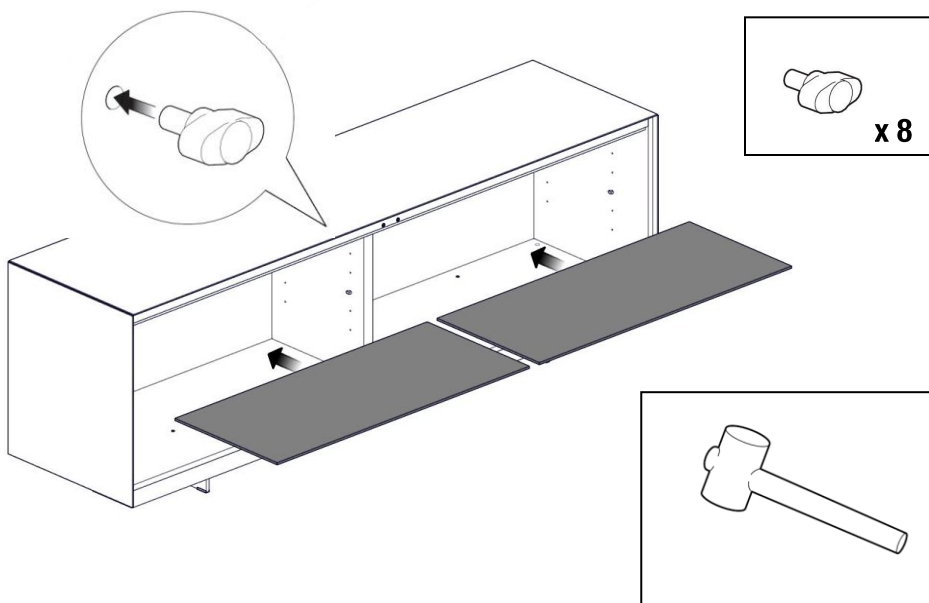

6

4 punti di regolazione
4 fixing points

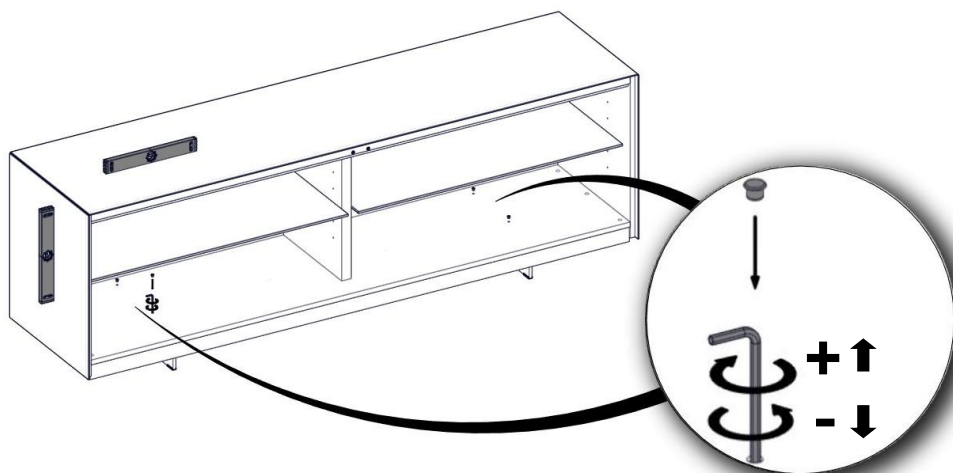
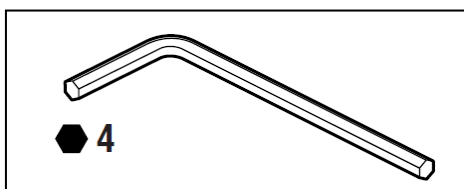

7

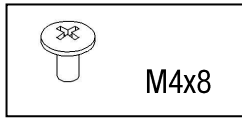
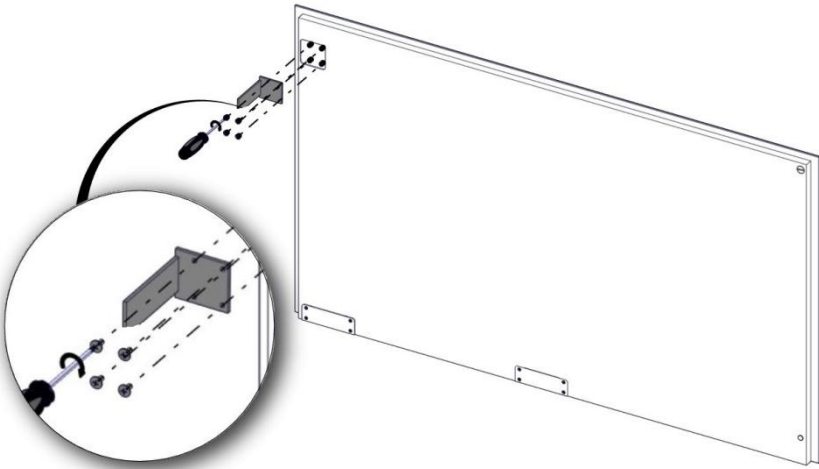

M4x8

x 2

8

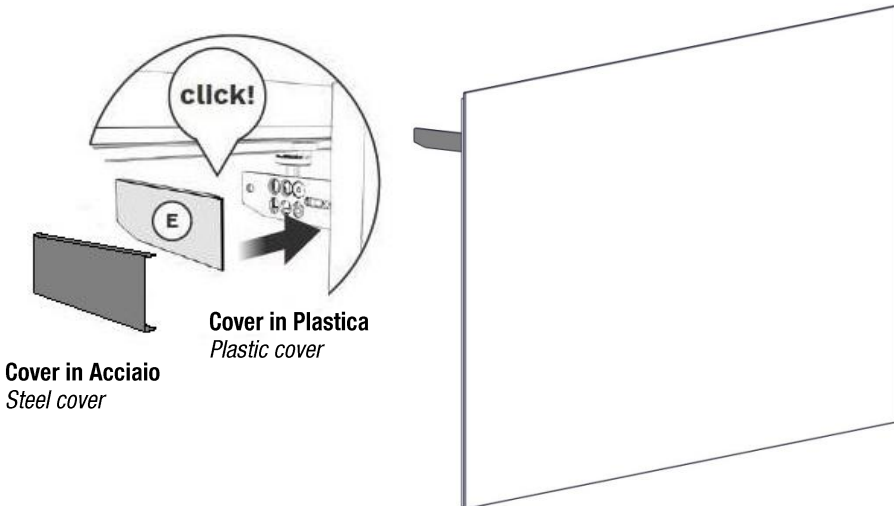

9

Fissaggio e regolazione superiore ante Upper door insertion and adjustment

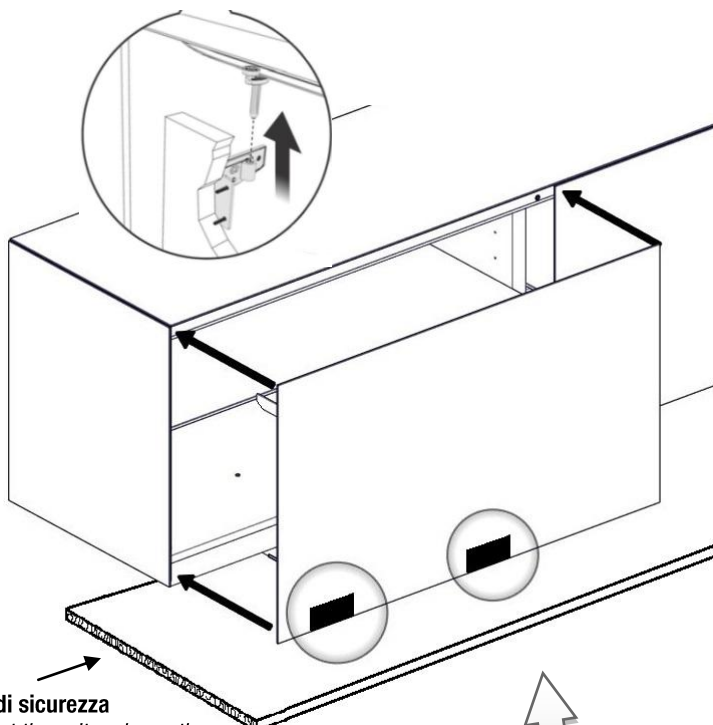

Protezione di sicurezza

Please protect the unit underneath
to avoid any damages to the front

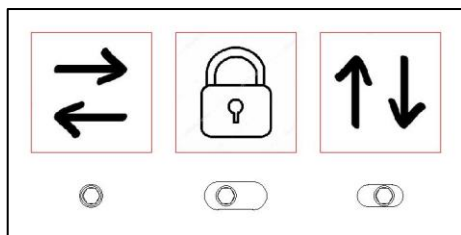
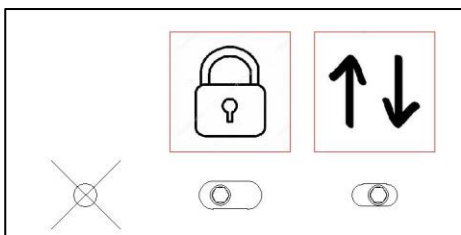

10

Chiave in dotazione
Supplied wrench

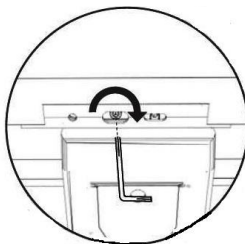
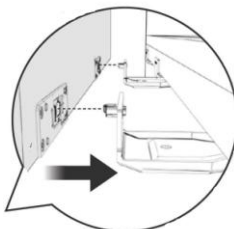
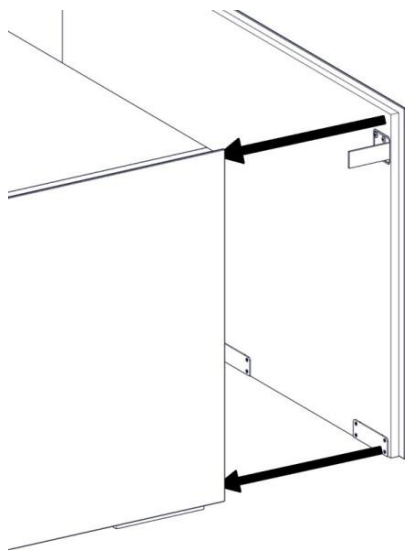
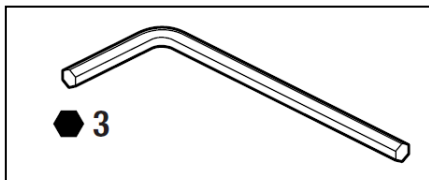

Bloccaggio inferiore ante
Door locking

11

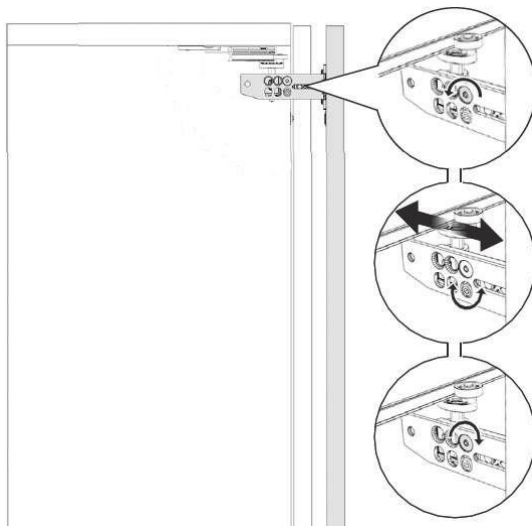

12

Fissaggio e regolazione superiore ante *Upper door insertion and adjustment*

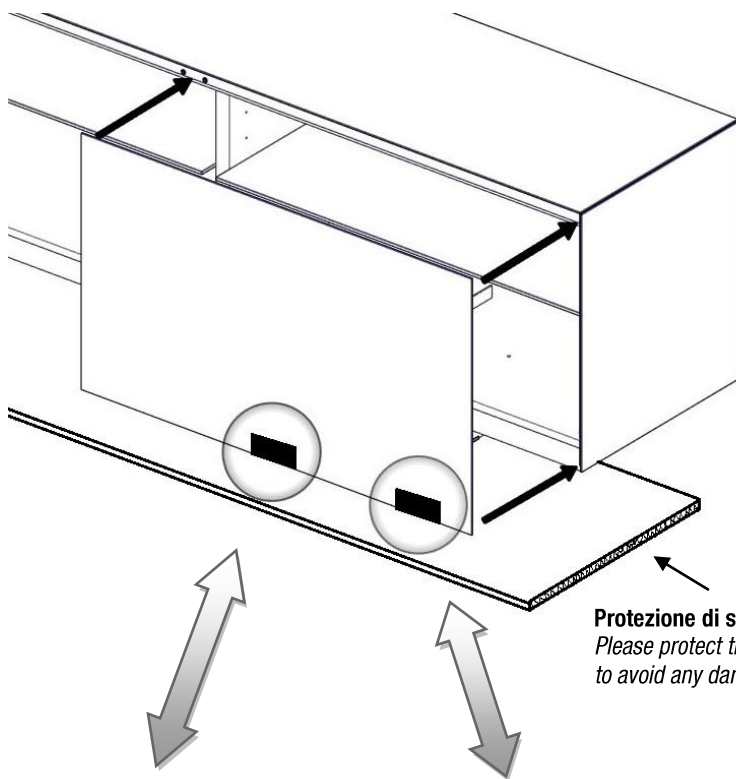

Protezione di sicurezza
*Please protect the unit underneath
to avoid any damages to the front*

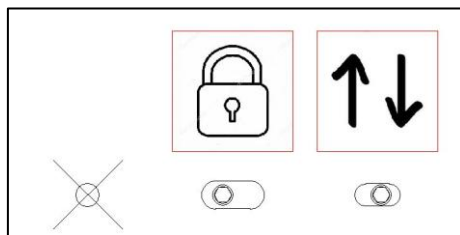
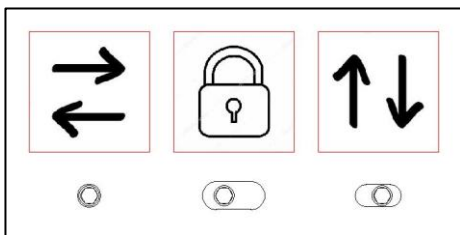

13

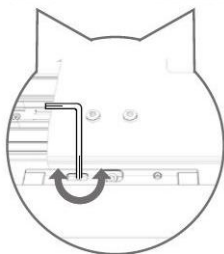
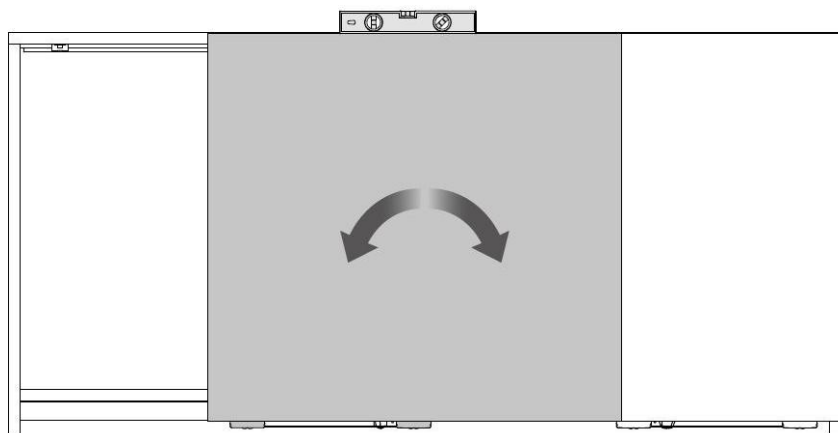
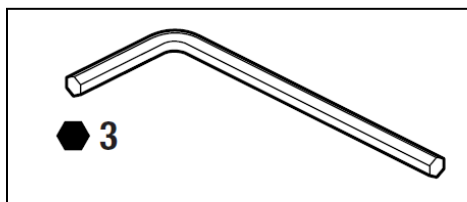
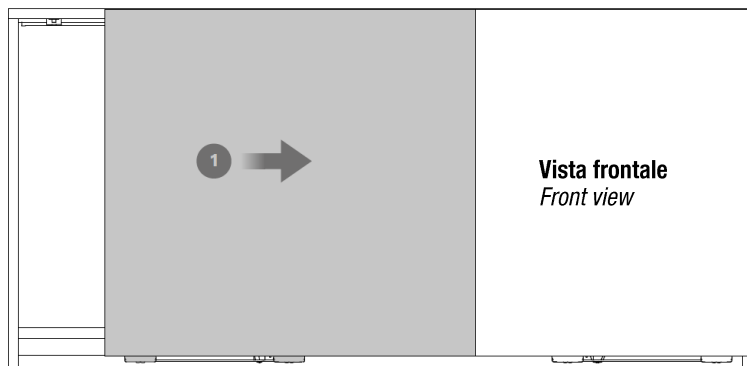

Regolazione bolla
Level adjustment

Regolazione orizzontale
Horizontal adjustment

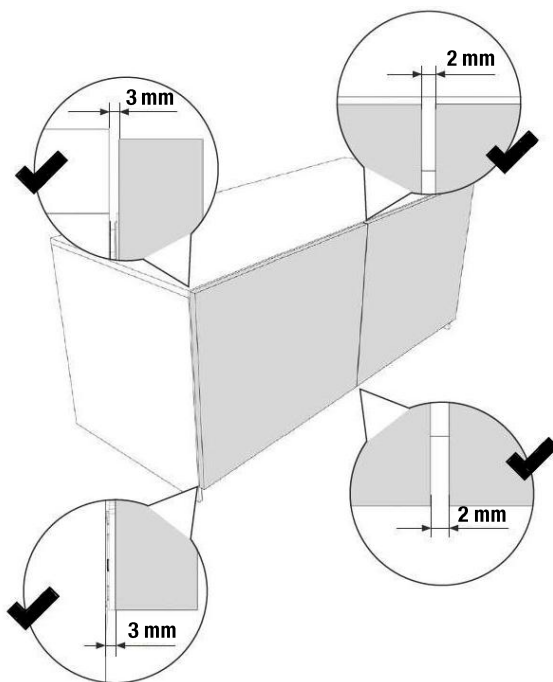
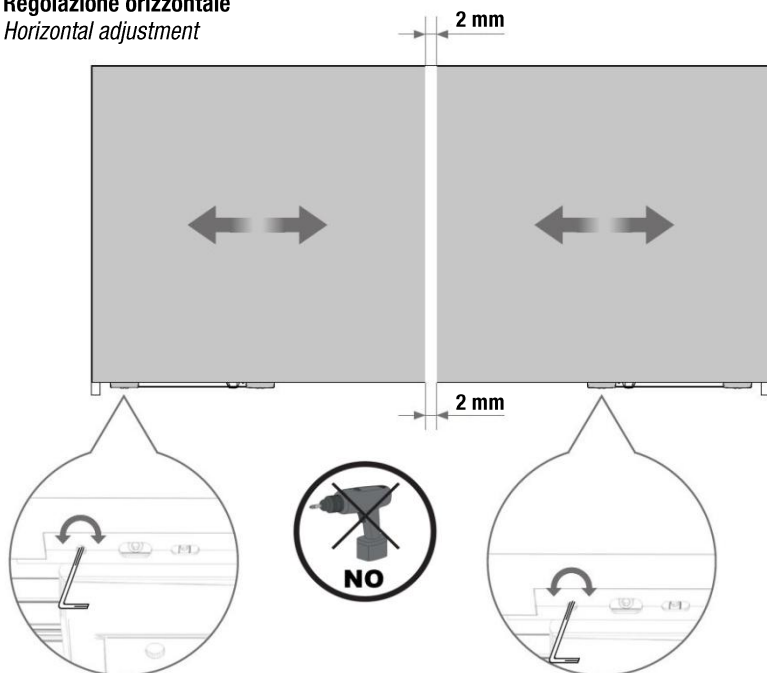

Lago spa declina ogni responsabilità per danni a cose o persone nel caso non vengano osservate tutte le norme antinfortunistiche e il montaggio non sia eseguito in conformità alle sue indicazioni e istruzioni; si riserva inoltre di apportare senza preavviso ed in totale libertà operativa ogni e qualsiasi variante e miglioria d'ordine funzionale-tecnico ed estetica.

Lago spa declines all responsibility for any damage to things or people when health and safety regulations have not been complied with and fitting instructions have not been adhered to. Moreover, the manufacturer reserves the right to bring about any technical-functional and design change or improvement, without any previous notice and with the utmost operational freedom.

Lago Spa

Via dell'Artigianato Il 21 – 35010 – Villa del Conte (PD) – www.lago.it